

O2X

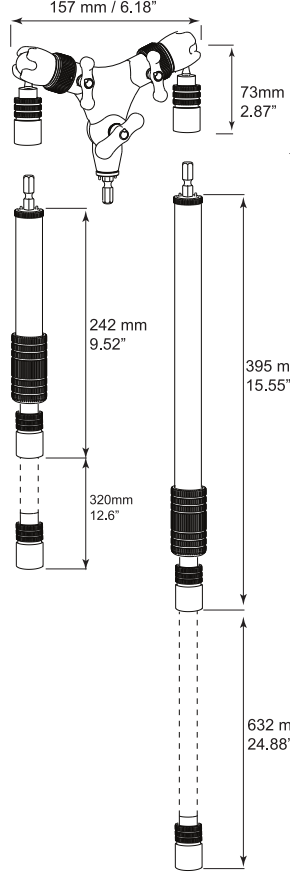

OA

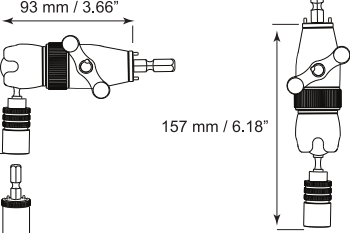

Model	Collapsed size	Max Length	Total Weight
OA	93 mm x 73 mm	157 mm	1.4 lbs / 0.635 kg
IO-W	93 mm x 73 mm	157 mm	0.44 lbs / 0.2 kg
IO-C	100 mm x 30 mm	100 mm	0.38 lbs / 0.17 kg
O2X	157 mm x 73 mm	157 mm	4.5 lbs / 2.04 kg
IO-A1	242 mm	320 mm	0.9 lbs / 0.41 kg
IO-A2	395 mm	632 mm	1.35 lbs / 0.61 kg

IO-W

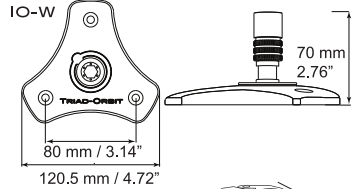

IO-C

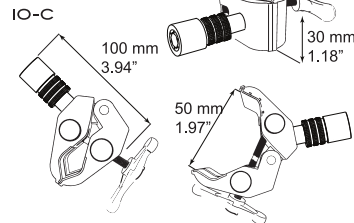

OA™

Orbit OA is a single freestanding version of a single Orbit 2-type orbital boom arm. Attach OA to an IO-W wall plate for instant connectivity to walls, ceilings, consoles, etc.

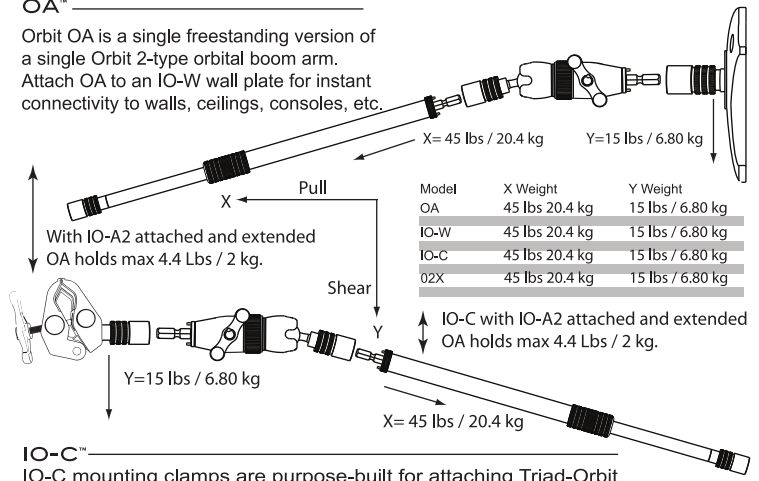

IO-C™

IO-C mounting clamps are purpose-built for attaching Triad-Orbit IO-equipped adaptors, boom arms, tablet holders, and assorted camera accessories to stands, trusses, tabletops and other parallel surfaces. Add Orbit OA boom arms and IO-A telescopic straight arms to IO-C clamps for instant device mounting solutions.

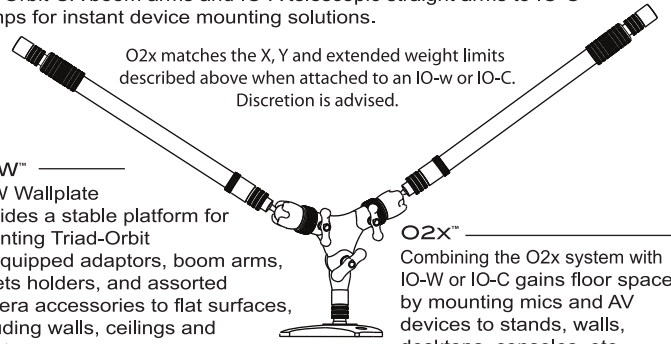

IO-W™

IO-W Wallplate provides a stable platform for mounting Triad-Orbit IO-equipped adaptors, boom arms, tablet holders, and assorted camera accessories to flat surfaces, including walls, ceilings and desktops.

O2x™

Combining the O2x system with IO-W or IO-C gains floor space by mounting mics and AV devices to stands, walls, desktops, consoles, etc.